

# CITY OF CHARLOTTESVILLE

DEPARTMENT OF PUBLIC WORKS  
FACILITIES DEVELOPMENT  
305 4<sup>th</sup> St. NW, Charlottesville, VA 22903  
Phone (434) 970-3302

## ADDENDUM NO. 3

RFQ# PW ADMIN TRAINING ROOM  
Addendum Date: 07/27/2020

### TO ALL BIDDERS:

**Project: Public Works Admin. Building Training Room**  
**RFQ#: PW ADMIN TRAINING ROOM**  
**RFQ Date: 07/02/2020**

The following constitutes an addendum to the Contract Documents issued for bidding on 07/02/2020. This addendum shall be attached to the Contract Documents and shall be part thereof to the same extent as if it were originally included. The contractor shall be responsible for coordinating these changes as they affect other work in the Contract Documents. Bidders shall acknowledge receipt of this addendum on their bid form. The Contents of this Addendum alter and amend the original drawings and specifications and take precedence over the related items therein. **THERE IS NOT A CHANGE TO THE TO THE BID OPENING DATE OR TIME BY THIS ADDENDUM.**

---

#### I. Questions submitted:

Q: Please clarify note 1 on sheet A111 calls out for ceiling tile per specs. But no specs are shown on drawings.

A: **We should have included a note on the RCP or in the SPEC sheet to address the clg tile selection; the BOD for new drop clg tile and frame is 24x24 ACT by Armstrong, "LYRA HIGH CAC #870 PF; Square Tegular Tiles with Prelude 15/16" Suspension System"**

Q: What is the existing deck ceiling height from finished floor?

A: **The drop clg is at approx. 9'=9" above the finished floor (at the lowest point in this room); I do not have an existing detail for this building that shows the roof deck or plenum space. Based on observation, I believe that we have at least 24" of space and likely more at this location.**

- II. **Site Restrictions:** This is an occupied construction project. Due to the Pandemic, we are requiring that Staff for this project access the job site from 4<sup>th</sup> Street Only. Parking will be reserved on 4<sup>th</sup> Street for this purpose. Additionally, we are restricting site staging. See attached layout that illustrates site access. The City of Charlottesville prefers to recycle waste and divert from the landfill however, a dumpster may be placed on 4<sup>th</sup> Street. Space will be reserved on 4<sup>th</sup> Street for this purpose.
- III. Please refer to COVID-19 Policy issued in Addendum 02 and note that, as a part of this project **in addition to requiring a Portable Toilet equipped with Hand Sanitizer, we are now requiring a Portable Wash Station.** This is a change please consider this in your pricing.
- IV. Please refer to the COVID-19 Policy issued in Addendum 02 and note that, as a part of this project, **daily temperature screenings are required for all staff working on this job.** Logs will be maintained and inspected; a thermometer will be provided for your use. Additional detail will be provided to the Bidder prior to starting the work on site.
- V. A list of Bidders invited to bid is attached. The list is referred to as a "Bidders List" but this does not reflect actual Bidders for the project.
- VI. ATTACHMENTS:
  - 1) Site Restrictions, Map
  - 2) Bidders List

**END OF ADDENDUM**



PW ADMIN BUILDING  
TRAINING ROOM IMPROVEMENTS

STAGING PLAN

THE CITY OF  
CHARLOTTESVILLE  
Department of Public Works  
Facilities Development  
305 4th Street, N.W.  
Charlottesville, VA 22903

Date: 07/23/20

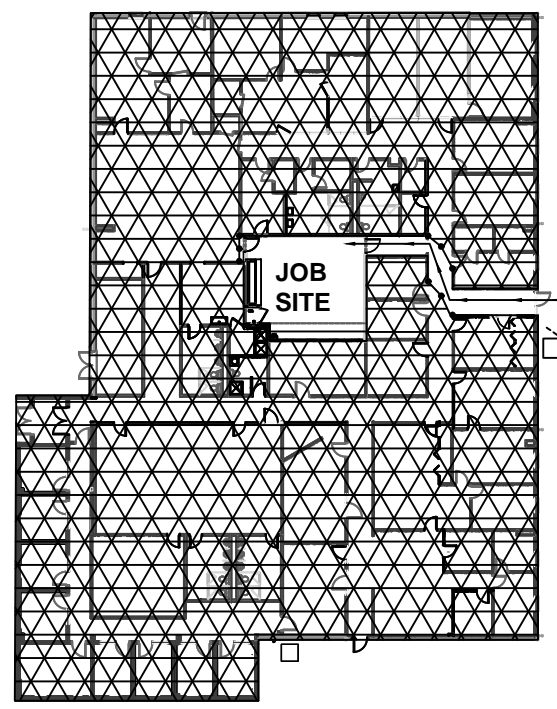

CONSTRUCTION  
PARKING WILL BE  
RESERVED ON 4TH ST.

CONSTRUCTION  
ENTRANCE  
ON 4TH ST.

PORTABLE TOILET  
&  
HAND WASHING  
STATION

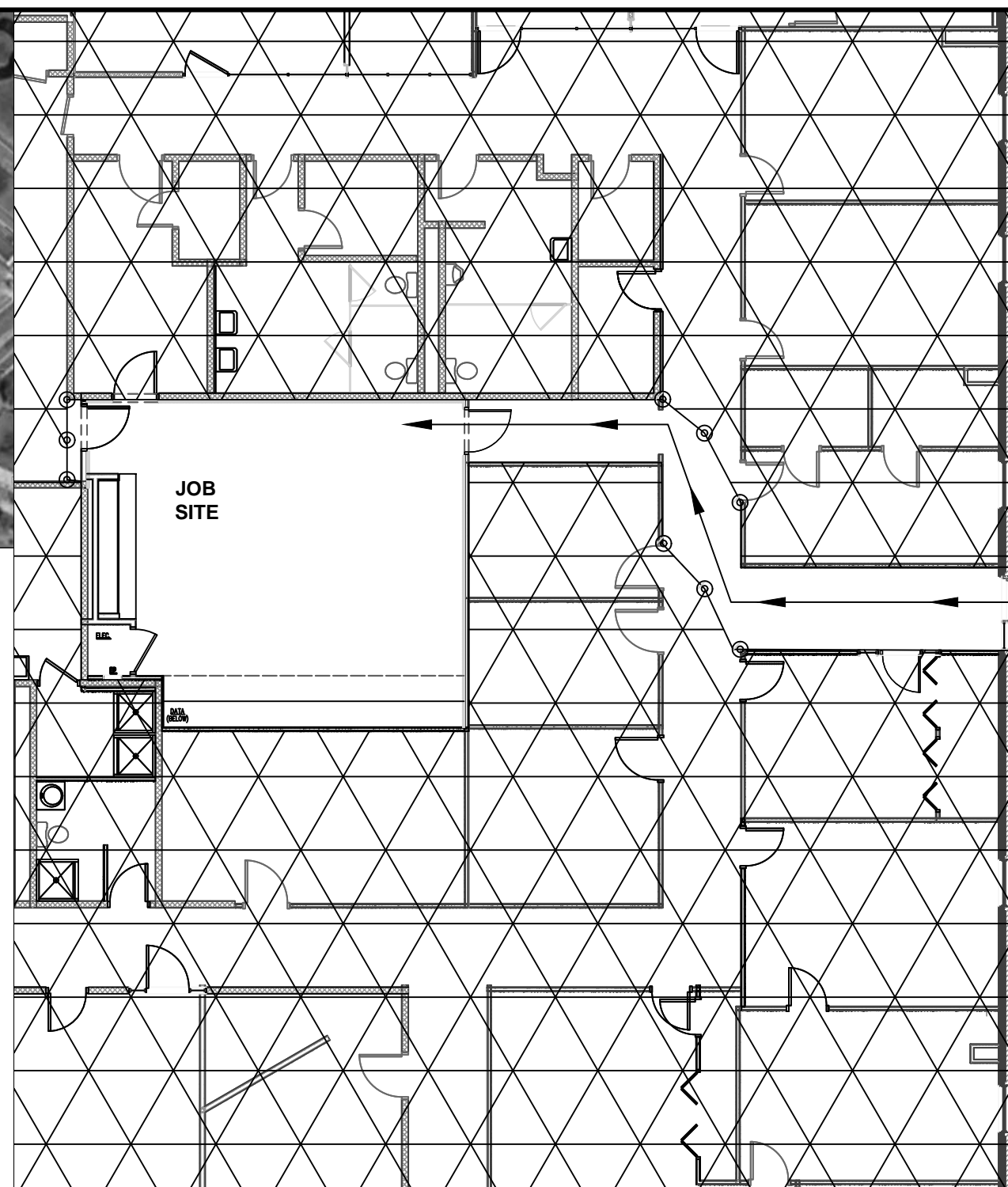

CONSTRUCTION  
ENTRANCE  
ON 4TH ST.

PORTABLE TOILET &  
HAND WASHING STATION

ABOVE: EXTERIOR STAGING

ABOVE: INTERIOR STAGING

KEY

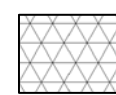

INDICATES RESTRICTED AREAS: TRAVEL & STAGING NOT PERMITTED



STANCHIONS IN HALL TO BLOCK TRAVEL



**BIDDER'S LIST**  
**PW ADMIN TRAINING RM RFQ**

	<u>VENDOR NAME</u>	<u>CONTACT</u>	<u>EMAIL</u>	<u>TELEPHONE</u>	<u>SAP VENDOR #</u>	<u>SWAM-O</u>	<u>DBE</u>
1	Coleman Adams Construction	D. COLEMAN	<a href="mailto:tcasto@coleman-adams.com">tcasto@coleman-adams.com</a> ; <a href="mailto:gdevol@coleman-adams.com">gdevol@coleman-adams.com</a>	434-973-9646	22291	-	-
2	Daniel & Company	Daniel, Samuel	<a href="mailto:swd@danielco.net">swd@danielco.net</a> ; <a href="mailto:estimating@dar">estimating@dar</a>	804-213-0400			
3	<b>Harrisonburg Construction</b>	<b>JARED ANDREWS</b>	<a href="mailto:jerry@harrisonburgconstruction.com">jerry@harrisonburgconstruction.com</a>	<b>434-296-0122</b>	<b>2678</b>	<b>6647 (S)</b>	<b>-</b>
4	Jamerson-Lewis Construction	T. WYATT	<a href="mailto:info@jamersonlewis.com">info@jamersonlewis.com</a> ; <a href="mailto:TWYATT@jamersonLEWIS.com">TWYATT@jamersonLEWIS.com</a>	434-845-3468	22309	710204 (S)	-
5	<b>J&amp;A</b>	Justin Flevarakis	<a href="mailto:U9lightning@aol.com">U9lightning@aol.com</a>	<b>434-296-7885</b>			
6	<b>First Class Contracting</b>	<b>TOM</b>	<a href="mailto:tom@FCCGC.com">tom@FCCGC.com</a>				
7	Lantz Construction Co.	Steven Hottle	<a href="mailto:shottle@lantzcc.com">shottle@lantzcc.com</a>	540-896-8911			
8	Nielsen Construction, Inc.	James Delucas, Jr.	<a href="mailto:delucasi@nielsen-inc.com">delucasi@nielsen-inc.com</a>	540-434-7376			
9	PD Interiors	Gary Haney	<a href="mailto:garhanpd@ntelos.net">garhanpd@ntelos.net</a>	(540) 942-4407			
10	<b>Snow's General Merchandise Inc.</b>	Joel Snow	<a href="mailto:joelsnw@gmail.com">joelsnw@gmail.com</a>	<b>434-985-6613</b>			
11	<b>Woodland Construction, Inc.</b>	John T. Selko	<a href="mailto:jselko@woodlandconst.com">jselko@woodlandconst.com</a>	<b>804-360-0545</b>			
12	<b>Ceiling &amp; Floor Shop</b>	Blake Simpson	<a href="mailto:Blake.Simpson&lt;bsimpson@ceilingandfloor.com&gt;">Blake Simpson &lt;bsimpson@ceilingandfloor.com&gt;</a>				
13	Artisan	Paul LeRoy	<a href="mailto:pleroy@artisaninc.com">pleroy@artisaninc.com</a> ; <a href="mailto:apeters@artisaninc.com">apeters@artisaninc.com</a>				
14	<b>Pincus Construction</b>	Michael Pincus	<a href="mailto:mikep@pincusconstruction.com">mikep@pincusconstruction.com</a> ; <a href="mailto:stacys@pincusconstruction.com">stacys@pincusconstruction.com</a>				

FLOORS ONLY/CLGS M

[commrdandc@gmail.com](mailto:commrdandc@gmail.com)  
[cwright@hodgmansinc.com](mailto:cwright@hodgmansinc.com)  
[washingtonandwashington@gmail.com](mailto:washingtonandwashington@gmail.com)  
[PhoenicianInteriors@live.com](mailto:PhoenicianInteriors@live.com)

Vendor Name	Enter the name of the vendor that the solicitation is being sent to
Contact	Enter the vendor's contact person
Email	Enter the contact person's email address
Telephone	Enter the contact person's telephone number
City Vendor	Enter the vendor's SAP vendor ID number, if applicable
SWAM-O	Small-Owned, Woman-Owned, Minority Owned, Micro-Owned Business; to determine if the vendor is SWAM-O, visit <a href="http://www.sbsd.virginia.gov">www.sbsd.virginia.gov</a> . If the vendor is certified; enter their SWAM-O number. For non-federally funded procurements.
DBE	Disadvantaged Business Enterprise, Woman Business Enterprise, Minority Business Enterprise; to determine if the vendor is DBE, visit <a href="http://www.sbsd.virginia.gov">www.sbsd.virginia.gov</a> . If the vendor is certified, enter their DBE number. For federally funded procurements.